

Episode Engine

Adapting your Media

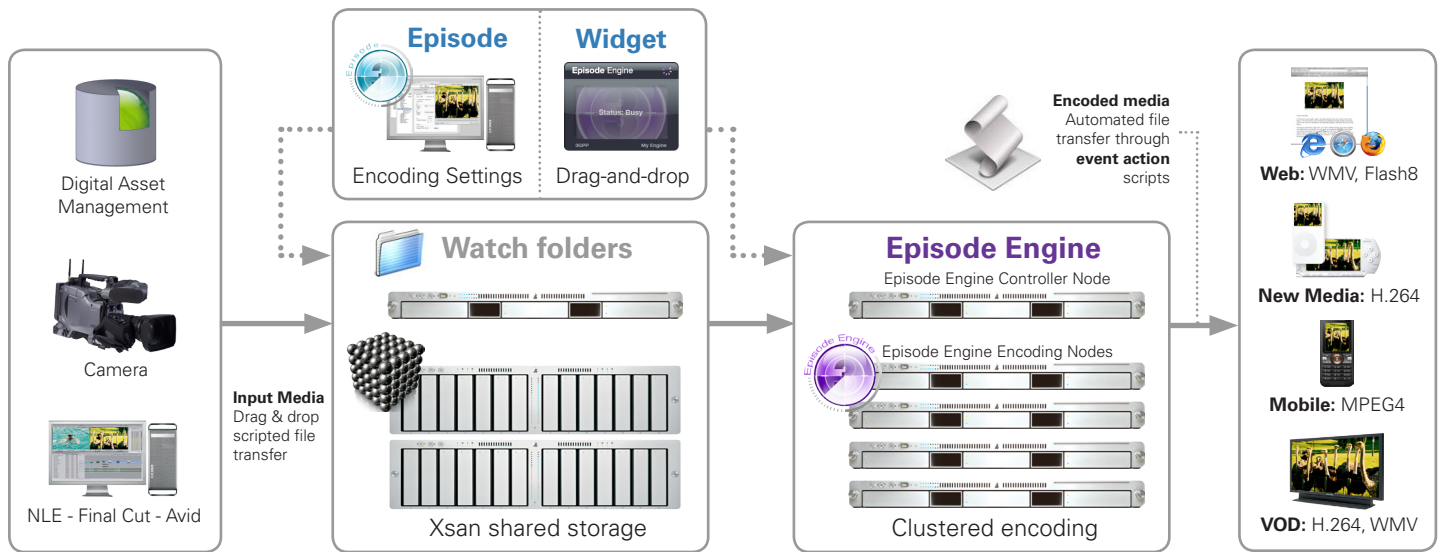
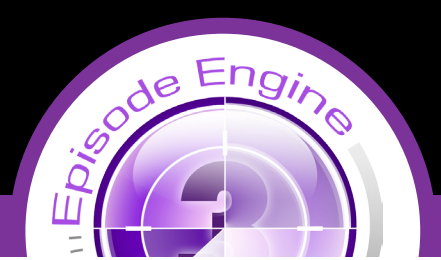

Encode any format in faster-than-real-time

Episode Engine is the smart choice for broadcast, post-production and new media workflows. Professionals worldwide rely on Episode Engine's broad format support, scalability and automation to deliver unprecedented speed, performance and value.

Outstanding Quality and Ease of Use

Excellent quality is the trademark of Episode Engine. Plenty of easily adjustable filters allow you to fine-tune your media to achieve the highest quality output results.

New Dashboard Widgets make it even easier to use Episode. Already known for its ease of use, widgets add even greater convenience by providing a simple way to submit encoding jobs and streamline your workflow.

Automation

Episode Engine can be integrated into any media encoding workflow environment. Simply transfer the source media to your choice of watch folders, and Episode Engine will automatically begin the transcode process. You can remotely follow the progress of your jobs from any Mac OS X computer. Event Actions in Episode Engine facilitate for easy, automated, event-action-driven integration with your production workflow.

Extensive Format Support

Episode Engine is the smart choice for businesses in need of an automated and scalable solution for new media, DVD or post-production workflows. It allows you to transcode most input formats to the widest range of output formats such as Flash 8, Windows Media, and H.264. Repurpose media for television, archiving, DVD, second- and third-generation mobile phones, portable video players, PDAs, websites, handheld media players such as the Sony Playstation Portable® and the Apple video-enabled iPod® and much more. Whatever your encoding needs may be, Episode Engine will fulfill them.

Episode Engine Pro

For professional time-critical productions, requiring professional formats and the highest encoding speed available on the market, the Pro version of Episode Engine is the right option. Additional format support in Episode Engine Pro includes high-end broadcast formats such as MXF, GXF, H.264 High Profile and Transport Streams (in/out).

Ultimate Speed - Split-and-Stitch

Episode Engine and Episode Engine Pro provide ultra-fast, server-based media encoding. They are massively scalable to keep pace with the growth of your business. Start with an Episode Engine; when your encoding needs increase, you can easily add additional servers to create a cluster and use the full power of parallel encoding.

Episode Engine Pro also includes our unique Split-and-Stitch* functionality, providing speeds up to several times faster than real time, for any output format, such as Flash 8, Windows Media, H.264 and much more. If you are working with HD material and have a time-critical setup, upgrade to Episode Engine Pro and real time HD encoding is a snap!

High Availability

In addition Episode Engine Pro offers a High-Availability option with a redundant master node for 24/7 reliability in your mission-critical workflow.

* Split-and-Stitch provides the ability to split a large file, distribute each part to a different server for parallel encoding and stitch it back together at the end of the process into one output file, thus fully utilizing the performance of your server cluster.



Episode Engine

Adapting your Media

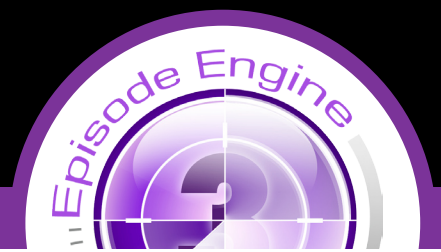

Speed

Split-and-Stitch (turbo encoding)
Parallel job processing
Multi-core architecture (maximum utilization of processors)

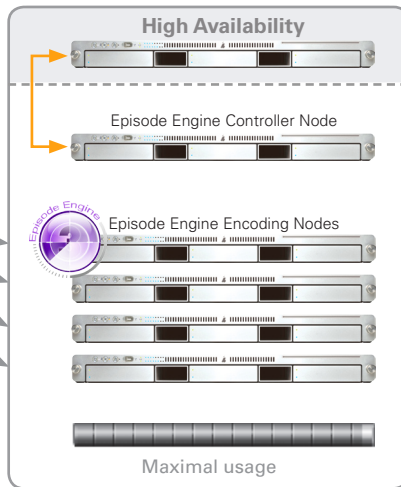
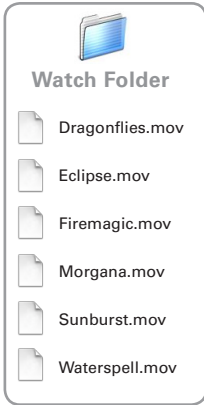

High Availability

Automatic re-submission in case of a slave failure
Redundant master assures no single point of failure

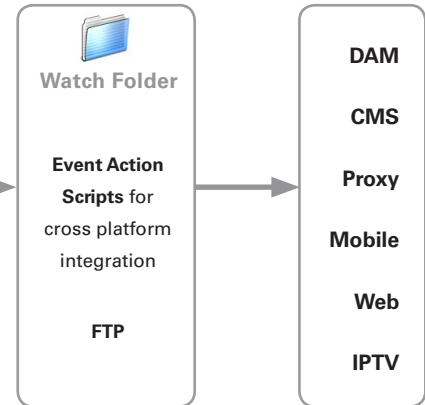

Automation

Speed

High Availability

Integration

Features

- **Watch folders** - used for automatic processing, up to 50 input watch folders
- **Engine Widget Client** - quick and easy job submission by drag-and-drop
- **Scalable through clustering** - you can cluster several Episode Engines
- **Event Actions** - automate your workflow using event triggered scripts
- **Bumpers and trailers** - add intro and outro movies to your content
- **Picture-in-Picture** - add a watermark to your content as a picture, animation or even as a movie
- **Support for metadata**
- **Support for timecode**
- **Advanced deinterlace filters** - produce the best possible progressive output even when the source material has been edited and cut
- **2 pass encoding** - (H.264, WMV, MPEG2/4, H.263) for maximum quality
- **Hinting (streaming)** - according to IETF, ISMA and 3GPP
- **Resizing and resampling algorithms** - give the best quality for small-screen, low-bandwidth display devices and when upscaling from SD to HD
- **Automatic input format detection** - video codec, audio codec, color sampling, frame rate, pixel aspect, audio sampling
- **Frame-rate conversion** - NTSC to/from PAL: 3:2 pulldown, 2:3 pulldown
- **Inverse telecine**
- **Fully configurable advanced color preprocessing filters** - (black and white restoration, HSV and gamma correction, noise removal, image sharpening...) ensuring the highest quality
- **Color adjustment filters** - improve the visual quality of less-than-perfect source material
- **Advanced audio filtering** - including normalize, balance, fade in/out, high/low pass and other advanced features

Pro adds:

- **Split-and-Stitch** - distributed encoding for **all output formats** enables maximum encoding speed
- **Unlimited number** of input **watch folders**
- **High Availability option** - for full robustness in cluster installations
- **SNMP** - System Management for network monitoring

Output Formats

Episode Engine provides superior format support for Web, Mobile, Apple TV, iPod, PSP, VOD, DVD, IPTV and Broadcast.

A few examples of formats supported by Episode Engine for encoding to different distribution channels:

- **Web:**
 - Flash 8 (available as an additional option)
 - Windows Media 9 (VC-1, WMA Pro, WMV, Intellistream MBR)
 - H.264
 - all QuickTime formats
- **Streaming / Mobile:**
 - 3GPP, 3GPP2, MP4 (MPEG-4, H.264, AMR, AAC)
 - Windows Media 9
- **Apple TV:**
 - H.264
- **iPod:**
 - H.264, MPEG-4, AAC
- **IPTV / Video On Demand:**
 - H.264, MPEG-2, VC-1
- **HD DVD:**
 - VC-1, H.264, MPEG-2
- **Audio only:**
 - AAC, MP3, WMA

Pro adds:

- **Streaming / Mobile:**
 - MP4 (HE-AAC)
- **Broadcast:**
 - Windows Media 9 (WMA Pro surround sound)
 - GXF, AMC,
 - Transport Streams (.ts), 3GPP multi-bit rate

For more information - visit Flip4Mac.com or Teletream.net

Specifications subject to change without notice. Copyright © 2007 Teletream, Inc. Teletream and Flip4Mac are registered trademarks and Episode is a trademark of Teletream, Inc. All other trademarks are the property of their respective owners.

May 2007

Contact us at:
www.flip4mac.com
www.teletream.net
Stockholm, Sweden
Nevada City, CA USA
tel +1 530 470 1300
episodesales@teletream.net